

# PROGETTO - APPARTAMENTO A

Piano Quarto  
H = 3,00 m

Via Capriati

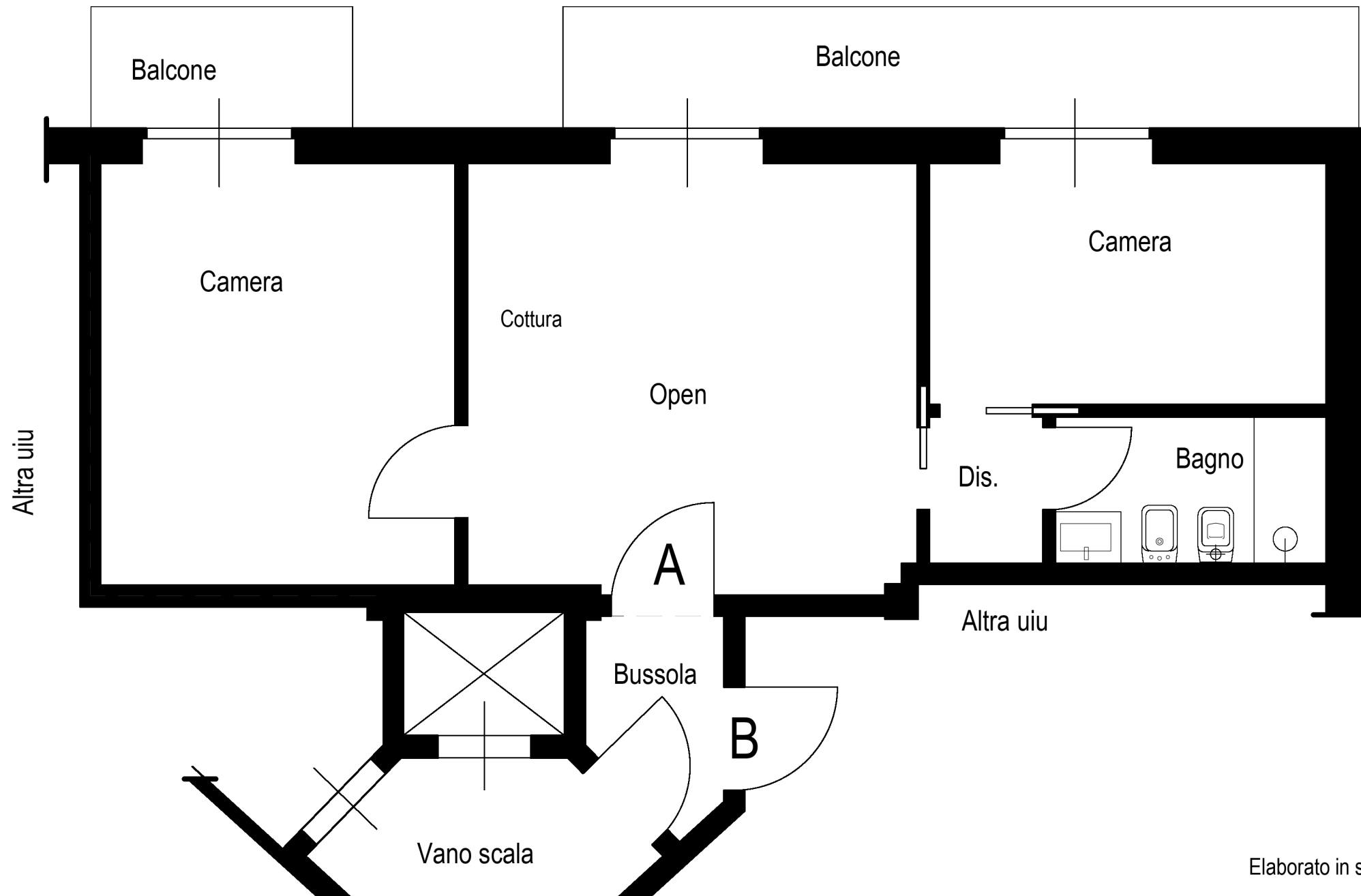

Elaborato in scala 1.50

IMMOBILE VIA CAPRIATI n. 8/A

BARI

*Sup. appartamento = 55,70 mq*

*Sup. balconi = 12,10 mq*

---

*Sup. commerciale = 59,73 mq*